



ND Department of Emergency Services Public Assistance Briefing

North Dakota Township Association Conference
December 3rd, 2019



Purpose

- Our Agency
- Public Assistance (PA) Program
- Declaration Process
- Fall Flood Declaration Status
- Damage Assessment Requirements
- Questions



Our Agency

- ND Department of Emergency Services (NDDDES)
 - Division of Homeland Security
 - Response
 - Recovery
 - Mitigation
 - Preparedness
 - Planning
 - GIS
 - Division of State Radio
 - Coordinate 9-1-1 services for emergency medical, fire, and law enforcement for 25 ND Counties and the designated backup for another 8 counties
 - Primary dispatch for Highway Patrol and other State and Federal Agencies



Recovery from Disasters

- Public Assistance (PA) Program
 - NDDDES uses the PA Program to repair damaged public infrastructure
 - Requires a Presidential Disaster Declaration
 - Declarations are always for a specific event, cannot be season wide
 - State threshold is \$1.53/person = \$1,029,064
 - County thresholds are \$3.84/person, so amount varies per county



Declaration Request Process

- After an event, local communities need to complete damage assessments
 - Damage assessments should be given to local POC (Emergency Manager or Highway Superintendent)
- If State has enough damages, NDDDES will conduct a Preliminary Damage Assessment (PDA)
 - NDDDES inspectors spot check local damage assessments for accuracy
- If State still has enough damages, NDDDES will write the Presidential Request for Governor's signature and, once signed, submit the request to FEMA



2019 Fall Flood

- Historic precipitation impacted the State from August through October
 - Wettest September in 125 years of records
- September 20 – 21 storm dropped historic amounts of precipitation, saturating everything
 - NDDES obtained damage assessments from impacted counties following this storm but was unable to hit State threshold
- Due to high ground saturation, the October 9 – 12 winter storm caused significant flooding in eastern ND



Current Status of Presidential Request

- Local Damage Assessments have been submitted
- Counties exceeding their thresholds are:
 - Barnes, Foster, Grand Forks, Kidder, LaMoure, Logan, Mountrail, Nelson, Sargent, Sheridan, Stutsman, Traill, Walsh, and Wells
- Current estimated dollar amounts are \$7.4 million
- PDA is being conducted this week
- Declaration Request is being written. Deadline for submittal is December 25th.



Damage Assessment Information

- Damage Assessments are vital for a community to identify their impacts and be included in a Presidential Declaration
- Damage Assessments need to include:
 - Site Trackers
 - Plat Maps
 - Material Cost Sheets
 - Photos
- Damages need to include dimensions, whenever possible
 - Saying how many loads or number of Cubic Yards is not enough info



Site Trackers

- Site trackers catalogue all damage sites into a single spreadsheet in a format FEMA will accept

Applicant Name	Site Name	County/City or Township	Category	Latitude	Longitude	Description of Damage or Work	Estimated Cost	% of Work Completed
Ransom County	RmCob01	Coburn	C	46.57293	-97.63218	Surface Gravel washed from road area 191' x 15' x 2". Road bed eroded over area 130' x 14' x 4"	\$ 450.00	100%
Ransom County	Ranso01	County	C	46.58489	-97.25158	40LF x 36" CMP eroded, washed out and was damaged beyond repair.	\$ 2,000.00	0%
Ransom County	Ranso02	County	B	46.44204	-97.68443	Force Account labor monitored flooded roadways, placed road closed signs, detour signs, road underwater signs, and placed sandbags throughout Ransom County.	\$ 14,251.25	100%
Ransom County	Ranso03	County	A	46.07134	-97.82892	Contractor and two Force Account employees worked from 5/8/2018-5/10/2018 to remove 80 CY of woody debris. Debris was taken to the Valley City landfill. GPS location of landfill - 46.54231, -98.02226.	\$ 4,578.55	100%



Plat Maps

- Plat maps are needed to verify damage site locations and GPS coordinates

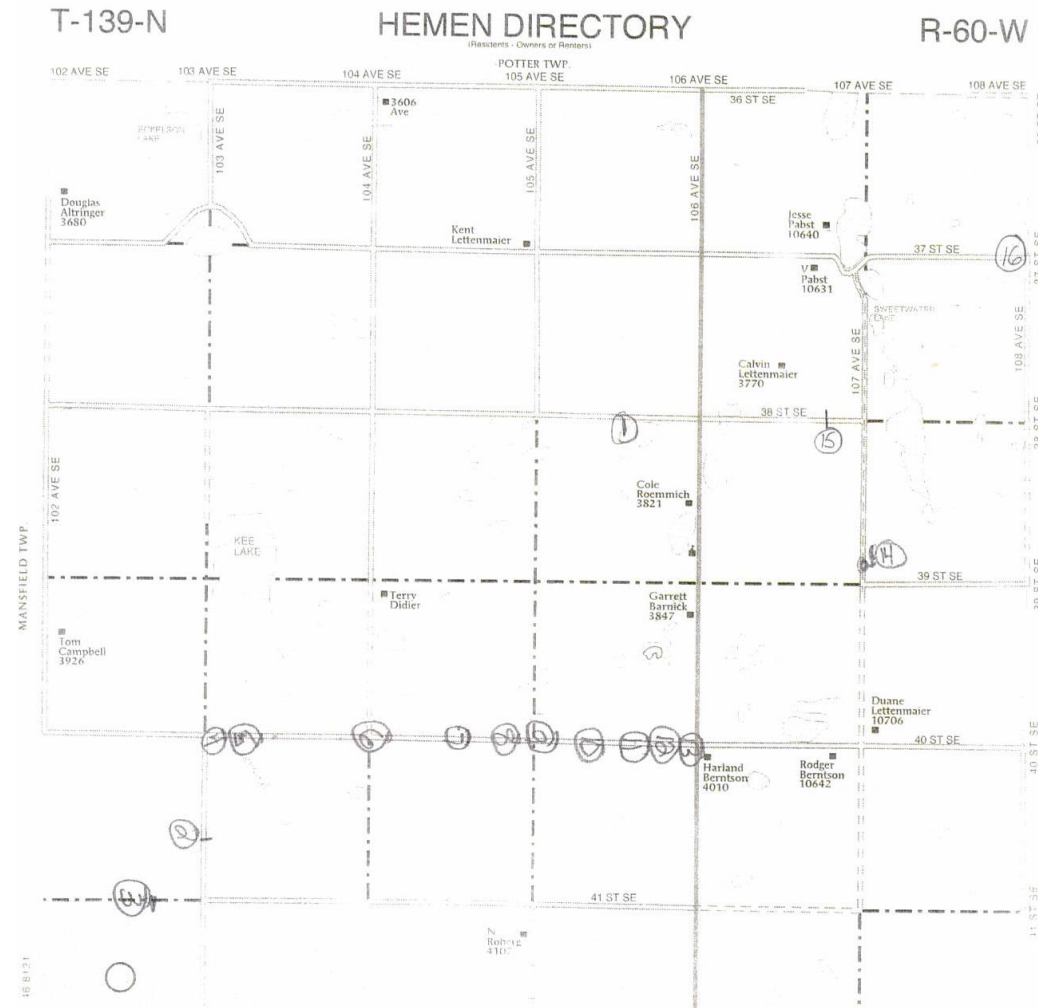



Material Cost Sheets

- Material Cost Sheets are needed to estimate the cost to repair sites back to pre-disaster condition.

Cost Listed below includes
Material Cost, Delivery and Placement.

Surface gravel.....	\$ <u>9.15</u> /CY
*Pit Run Gravel.....	\$ <u>9.15</u> /CY
*Embankment Material (Clay).....	\$ <u>9.15</u> /CY
Field Rock..... Field rock Field rock.....	\$ ^{17.00} 200.00 /CY
Rip Rap.....	\$ _____ /CY
Filter Fabric.....	\$ _____ /CY
Other <u>Contract - excavator</u>	\$ <u>100/hr</u> 1CY
(Specify)	

Culvert Price includes delivery 40 ft culvert - 714.00
32 ft culvert - 601.20

This form is being used to establish material costs. I certify that the cost indicated is supported with actual cost documentation.

Must include cost at the source. Contractor quote may be used.



Photos

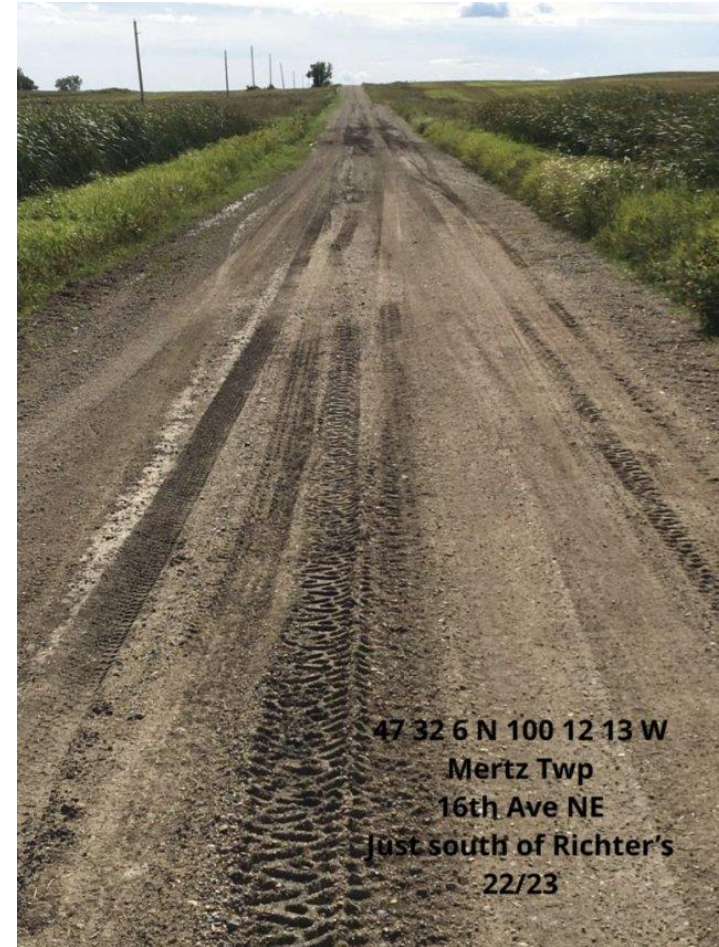



Questions?



Contact Information

- Justin Messner, Disaster Recovery Chief
 - 701-328-8107
 - jmessner@nd.gov

- Randy Reimer, Public Assistance Officer
 - 701-328-8262
 - rlreimer@nd.gov

- Brent Kahl, Public Assistance Closeout Supervisor
 - 701-328-8186
 - bmkahl@nd.gov